



Pradhan Mantri Awas Yojana (Urban)

Navjeevan Kusth Ashram, Jamshedpur - Affordable Housing Project

Project Site	Navjeevan Kusth Ashram, Jamshedpur
Project Area	6.5 acre
Total Dwelling Units / House	400
Area of each Dwelling Units / House	290.08 sq feet
Total Block	25
Flat/Block	16
Flat/Floor	4
Structure	Ground + 3
Total Project Cost	28.90 Cr.
Central Share	1.50 Lakh
State Share	5.72 Lakh
Beneficiary Share	0.00 Lakh
Per DU Cost	7.22 Lakh
Contractor	M/s JUSCO Ltd, Sakchi Boulevard Road, Northern Town Bistupur, Jamshedpur -831001
Implementing Agency	JUIDCO Ltd
For more detail Contact	Special Officer, Jamshedpur Notified Area Committee
Project Duration & Completion	18 month

Location Map & Site Plan

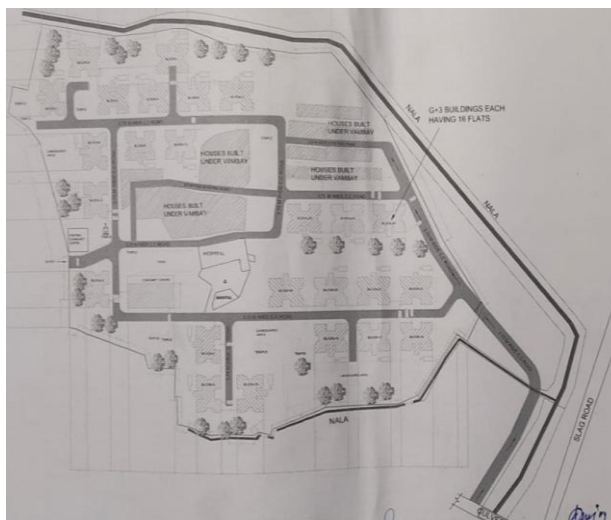

Layout Plan



Elevation Model



Directorate of Municipal Administration
Urban Development and Housing Department